

Material:

Housing: 30% Glass Filled PBT UL94V-0.

Contacts: Phosphor Bronze.

Electrical Characteristics:

Current Rating: 1 AMP.

Dielectric Withstanding Voltage: AC 750V For 1 minute.

Insulator Resistance: 10000MΩ min. at DC 500V.

Contact Resistance: 20mΩ max. at DC 100mA.

Operating Temperature: -55°C ~ +125°C .

***RoHS Compliant**

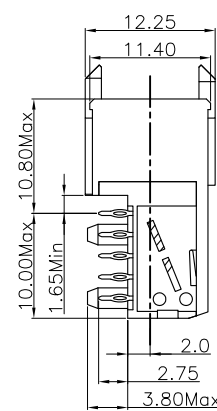
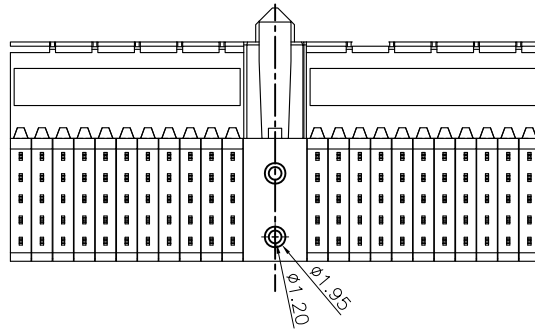

None Shielded

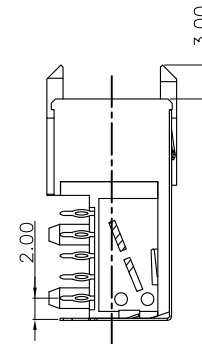

With Top Body Shielded

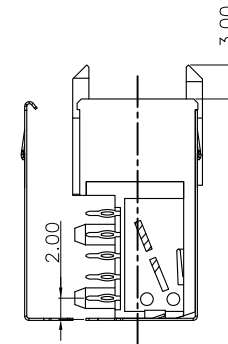

With Top Body Shielded and Bottom Shielded

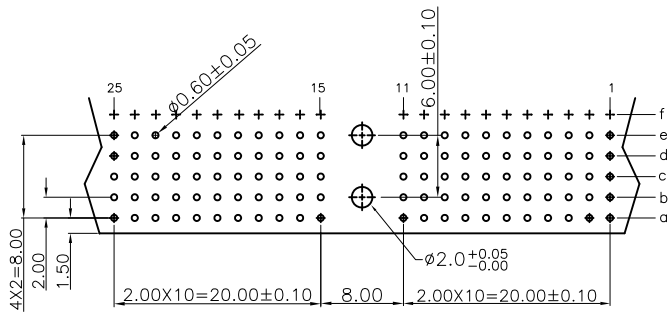

P.C. Board Layout
(Top View)

RoHS Compliant

TOLERANCES ARE

MORETHANALL
PCB CONNECTORS
Cable ASSEMBLIES
煜倫股份有限公司

DRAWING BY CY

CHECKED BY GENIUS

UNIT / mm

SCALE 1 : 1

DATE

SIZE A4

P PROJECTION

X, ±
.X ±
.XX ±
.XXX ±
ANG ±

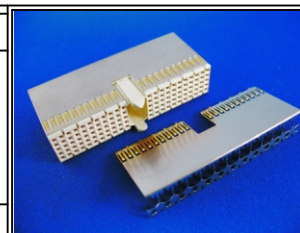

ORDER INFORMATION

HM7A-SQx-110-LF

SERIES | LEADFREE
110 WAY

FEMALE | X: NONE SHIELDED
T: WITH TOP BODY SHIELDED
A: WITH TOP BODY SHIELDED
AND BOTTOM SHIELDED

90° PRESS FIT

DESCRIPTION: