

Features:

- Material: Phosphor bronze
- Finished: Tin-plated

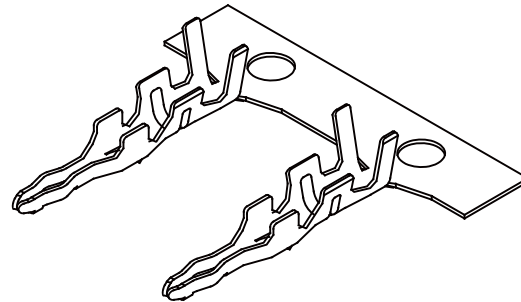

Specification:

- Current rating: 3A AC, DC
- Voltage rating: 250V AC, DC
- Ambient temperature range: -40°C ~ 105°C

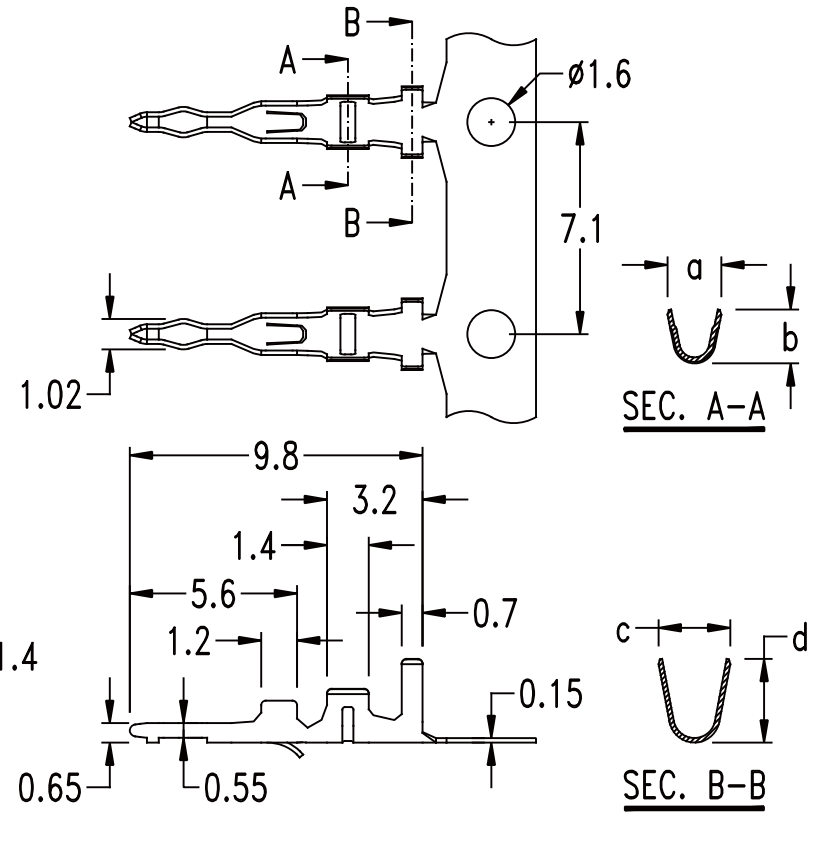

Ordering & Dimensional Information (mm)

Part No.	Wire range	Max. Dia. of Insulation	Q'ty/Reel	Dimension			
				a	b	c	d
SCM-T-22	#22 ~ #28	∅1.9mm	12,000	1.7	1.8	2.3	2.4
SCM-T-20	#20 ~ #22	∅2.1mm	10,000	1.8	1.8	2.4	2.8

RoHS Compliant

TOLERANCES ARE

MORETHANALL
PCB CONNECTORS
Cable ASSEMBLIES

DRAWING BY CY

CHECKED BY GENIUS

UNIT / mm

SCALE 1 : 1

DATE

SIZE A4

X, ±
.X ± 0.40
.XX ± 0.25
.XXX ± 0.08
ANG ±

PJECTION

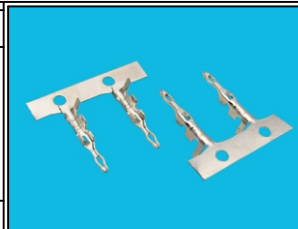

ORDER INFORMATION

SCM-T-xx-LF
SERIES | LEADFREE
20:20~22 AWG
22:22~28 AWG
TERMINAL

煜倫股份有限公司

www.morethanall.com

DESCRIPTION: .098"(2.5mm) Board-In Crimp Terminal