

PIN ASSIGNMENT:

Pin No.	Signal Name	Pin No.	Signal Name
P1	VBUS	P20	CC2
P2	TX1+	P19	D+
P3	TX1-	P18	D-
P4	GND	P17	GND
P5	RX1+	P16	RX2-
P6	RX1-	P15	RX2+
P7	VBUS	P14	GND
P8	CC1	P13	TX2-
P9	SBU1	P12	TX2+
P10	SBU2	P11	VBUS

NOTES:

***Material**

Housing&Cap: LCP, UL94V-0; Color: Black
 Insert plate (Molding): LCP, UL94V-0; Color: Black
 Contacts: Phosphor Bronze
 Plating: Au Plating On Contact Area;
 Ni(50u" Min.) Underplating Overall;
 Sn(100u" Min.) Plating On Solder Tail.

Shell: SUS;
 Plating: Ni(40u"Min.) Plated Overall;
 Sn(60u"Min.) Plating On Solder Tail.

***Mechanical**

Mating Force: 35N Max.
 Unmating Force: 15N Min.
 Durability: 50 Cycles

***Electrical Specification**

Current Rating: 3A
 Voltage Rating: 5V
 Contact Resistance: 40mΩ Max.
 Insulation Resistance: 100MΩ Min.
 Dielectric Withstanding Voltage: 100V AC Min.

***Environmental**

Operating Temperature: -55°C To +85°C

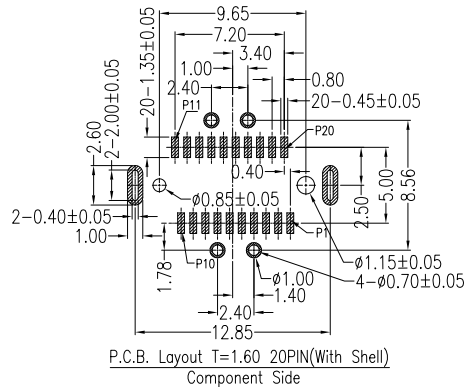
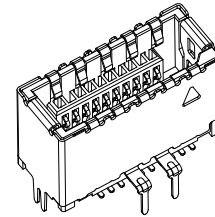
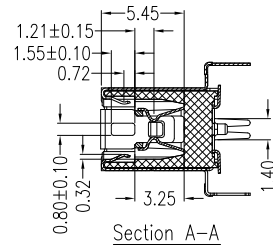
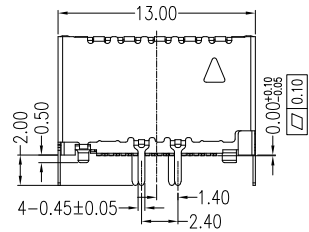
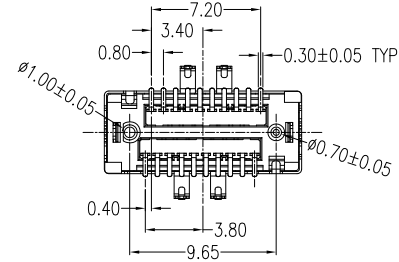
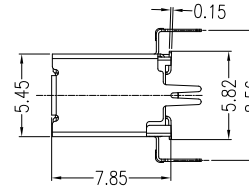
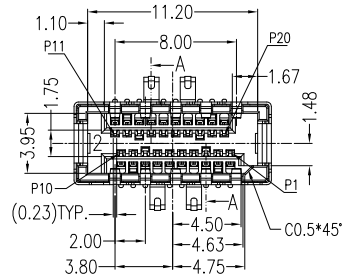

RoHS Compliant

TOLERANCES ARE

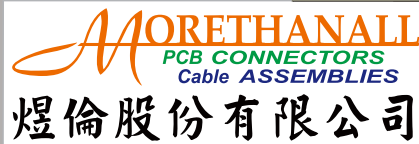

DRAWING BY CY

CHECKED BY GENIUS

UNIT / mm

SCALE 1:1

DATE

SIZE A4

PJECTION

X. ±
 .X ± 0.35
 .XX ± 0.25
 .XXX ± 0.15
 ANG ± 3°

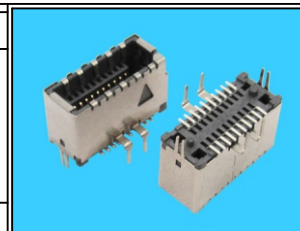

ORDER INFORMATION

USB-SVMPZMX-20C-LF
 SERIES | | | | LEADFREE
 | | | | 20 WAY C TYPE
 FEMALE | | | | NON SPRING
 180°SMT | | | | METAL FOOT
 METAL FOOT | CLIP | POST

DESCRIPTION: USB 3.1 Type C Internal Connecto (With Shell Key A Type)

www.morethanall.com