

MATERIAL
 INSULATOR: GLASS-REINFORCED THERMOPLASTIC PPS.
 CONTACT: COPPER ALLOY.
 PLATING: MATING AREA - SELECTED GOLD OVER NICKEL.
 SOLDER AREA - TIN OVER NICKEL.

ELECTRICAL
 VOLTAGE RATING: 250 VAC RMS.
 CURRENT RATING: 1 AMP
 DIELECTRICAL WITHSTANDING VOLTAGE: 500 VAC RMS 60 Hz FOR 1 MINUTE.
 INSULATION RESISTANCE: 1000 MEGOHMS MIN AT 500 VDC.
 CONTACT RESISTANCE: 30 MILLIOHMS MAX AT 1 AMP DC.

MECHANICAL
 RETENTION FORCE: 460 GRAMS MIN PER CONTACT.
 INSERTION FORCE: 230 GRAMS MAX PER CONTACT PER.
 WITHDRAWAL FORCE: 15 GRAMS MIN PER CONTACT PER.

ENVIRONMENTAL
 TEMPERATURE RANGE: -55°C TO +85°C.

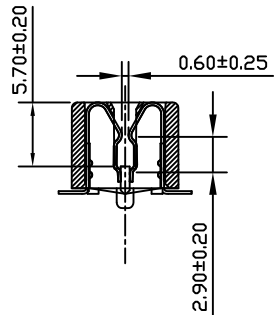

SECTION A-A

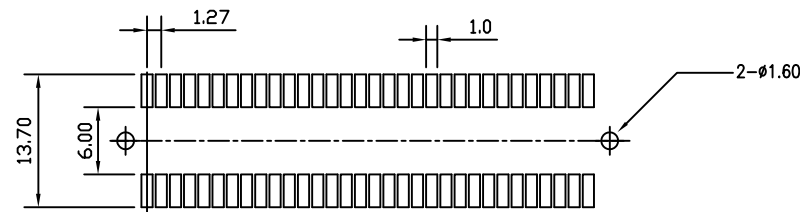

RECOMMENDED PCB LAYOUT (TOP VIEW)

Pin NO. \ DIM.	A	B	C	D
20PIN	16.26	13.97	11.43	15.09

RoHS Compliant

TOLERANCES ARE

MORETHANALL
 PCB CONNECTORS
 Cable ASSEMBLIES

煜倫股份有限公司

www.morethanall.com

DRAWING BY CY

CHECKED BY GENIUS

UNIT / mm

SCALE 1 : 1

DATE

SIZE A4

X. ± 0.40

.X ± 0.30

.XX ± 0.20

.XXX ± 0.10

ANG ±

PPOJECTION

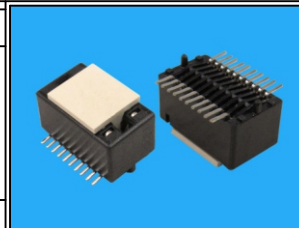

ORDER INFORMATION

HEL-V81PC-020-LF
 SERIES | | | LEADFREE
 | | | 20 WAY
 | | | CAP
 180°SMT | | POST
 | | HIGH 8.1mm

DESCRIPTION: 1.27 CARD EDGE SMT , POST TYPE LOW PROFILE