

**SPECIFICATIONS**

Current Rating: 2A AC,DC  
 Voltage Rating: 250V AC,DC  
 Temperature Range: -25°C ~ +85°C  
 Contact Resistance: 30mΩ Max.  
 Insulation Resistance: 1000MΩ Min.  
 Withstanding Voltage: 800V AC/minute  
 Material: Nylon 66,UL94V-0  
 Color: Black

**Ordering Information & Dimensions**

PART NO.	Dimensions	
	A	B
DF11-H-2X02	2.00	6.00
DF11-H-2X03	4.00	8.00
DF11-H-2X04	6.00	10.00
DF11-H-2X05	8.00	12.00
DF11-H-2X06	10.00	14.00
DF11-H-2X07	12.00	16.00
DF11-H-2X08	14.00	18.00
DF11-H-2X09	16.00	20.00
DF11-H-2X10	18.00	22.00
DF11-H-2X11	20.00	24.00
DF11-H-2X12	22.00	26.00
DF11-H-2X13	24.00	28.00
DF11-H-2X14	26.00	30.00
DF11-H-2X15	28.00	32.00
DF11-H-2X16	30.00	34.00
DF11-H-2X17	32.00	36.00
DF11-H-2X18	34.00	38.00
DF11-H-2X19	36.00	40.00
DF11-H-2X20	38.00	42.00

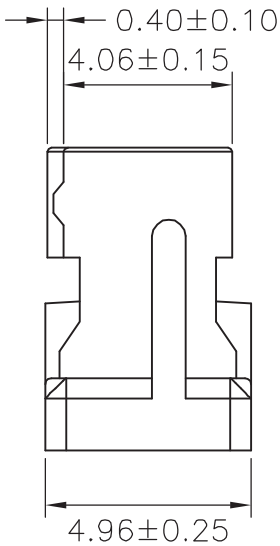
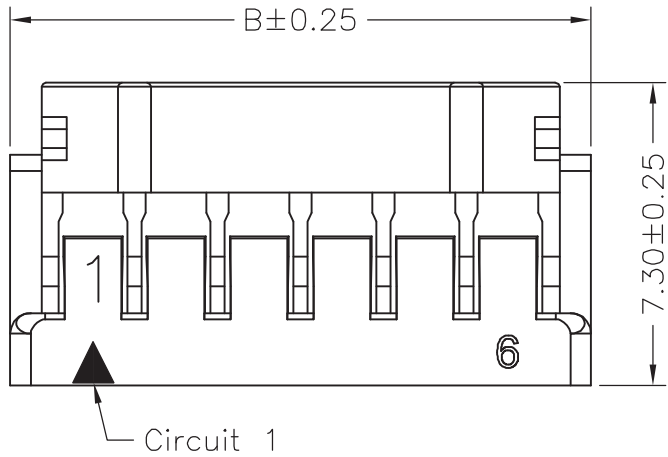
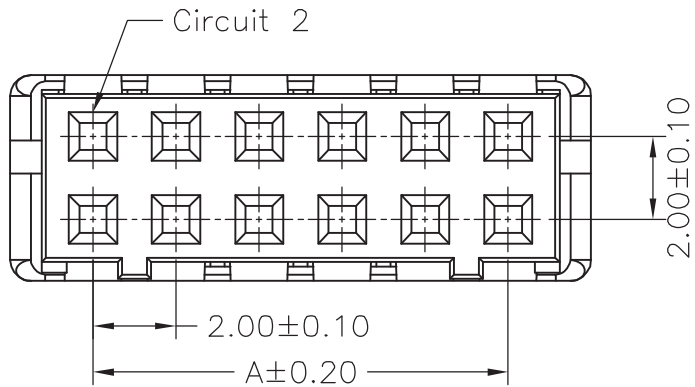
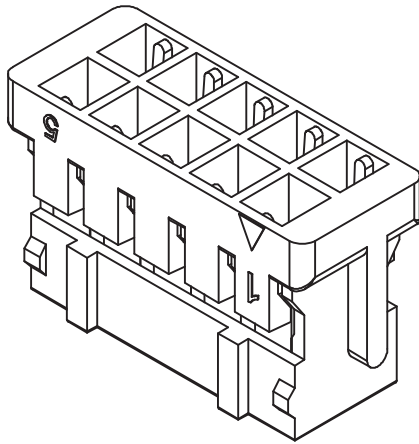

**RoHS Compliant**

TOLERANCES ARE

**MORETHANALL**  
 PCB CONNECTORS  
 Cable ASSEMBLIES

煜倫股份有限公司

www.morethanall.com

DRAWING BY CY

CHECKED BY GENIUS

UNIT / mm

SCALE 1:1

DATE

SIZE A4

PPOJECTION

X, ±  
 .X ±  
 .XX ±  
 .XXX ±  
 ANG ±

**ORDER INFORMATION**

DF11-H-2Xxx-LF

SERIES | LEADFREE  
 2X02:02WAY  
 2X20:40WAY  
 HOUSING

DESCRIPTION: 2.00mm PITCH HOUSING