

Notes:

MATERIAL:

Insulator: High Temperature Thermoplastic,
Color Black ,UL 94V-0.

Contact: Phosphor-Bronze

Shell: Stainless Steel

PLATING:

Contact: Plated 50u" Ni Overall

Plated Au Selective Contact Area

Plated 100u" Sn Over Ni On Solder Area

Shell: Plated 50u" Ni Overall

Plated Au Selective Solder Area

RoHS Compliant

TOLERANCES ARE

MORETHANALL
PCB CONNECTORS
Cable ASSEMBLIES

DRAWING BY CY

X. ± 0.50

CHECKED BY GENIUS

.X ± 0.30

UNIT / mm

SCALE 1 : 1

.XXX ±

DATE

ANG ±

SIZE A4

PPOJECTION

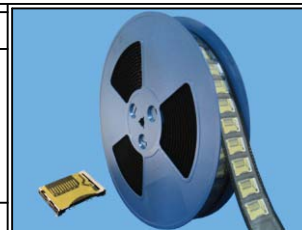

ORDER INFORMATION

MHC-W21R-601-LF
SERIES | REEL | POST 21.00mm | 90°SMT
LEADFREE
SD/MMC 6 IN 1

煜倫股份有限公司

www.morethanall.com

DESCRIPTION:

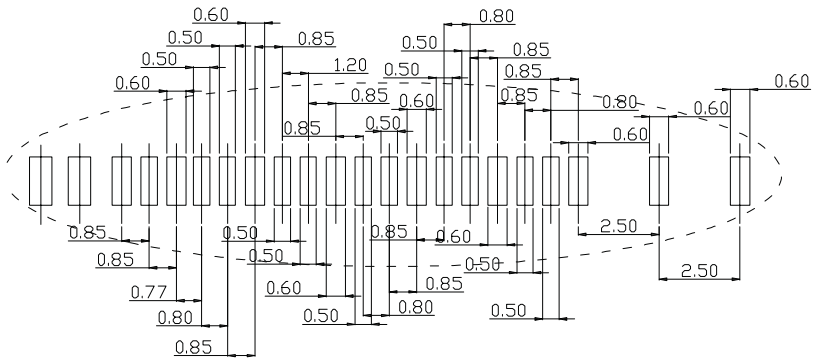

Detail A Scale 4:1

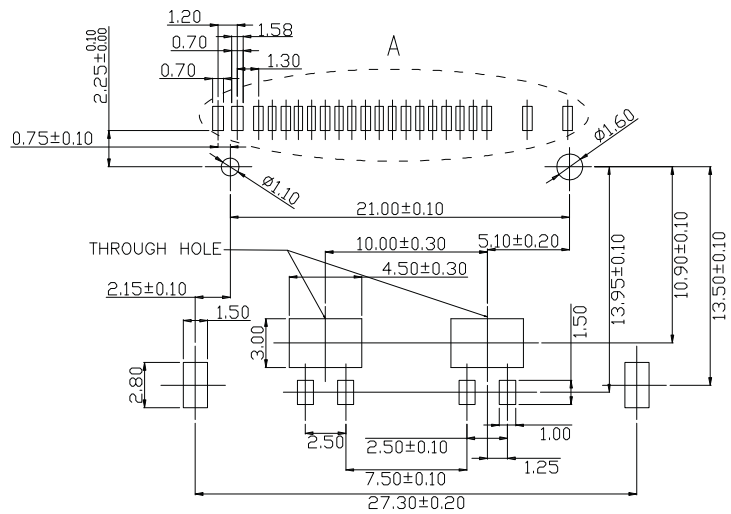

RECOMMEND PCB LAYOUT: (Unit:mm .X ± 0.15 .XX ± 0.05 .XXX ± 0.02)

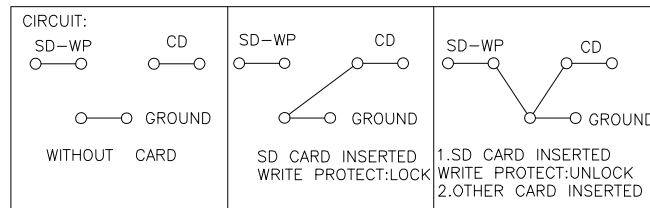
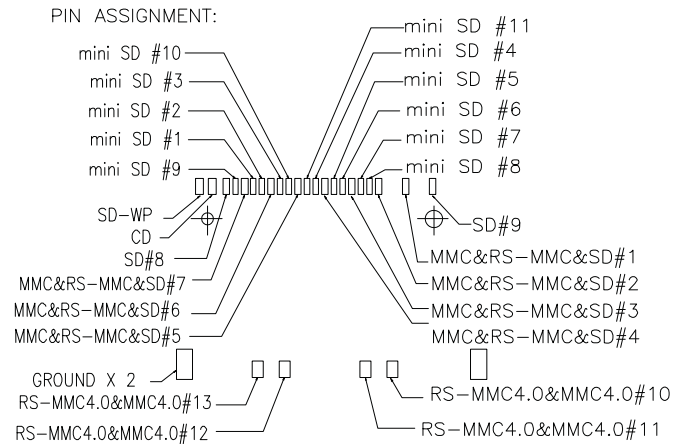

PIN NO.	MEMORY CARD PIN NO.
MMC4.0&MMC&SD#1	CD/DAT3
MMC4.0&MMC&SD#2	CMD
MMC4.0&MMC&SD#3	Vss1
MMC4.0&MMC&SD#4	VDD
MMC4.0&MMC&SD#5	CLK
MMC4.0&MMC&SD#6	Vss2
MMC4.0&MMC&SD#7	DAT0
MMC4.0&SD#8	DAT1
MMC4.0&SD#9	DAT2
MMC4.0
	DAT4
MMC4.0	DAT5
MMC4.0	DAT6
MMC4.0	DAT7
miniSD#1	CD/DAT3
miniSD#2	CMD
miniSD#3	Vss1
miniSD#4	VDD
miniSD#5	CLK
miniSD#6	Vss2
miniSD#7	DAT0
miniSD#8	DAT1
miniSD#9	DAT2
miniSD#10	NC
miniSD#11	NC

RoHS Compliant

TOLERANCES ARE



DRAWING BY CY X ± 0.50

CHECKED BY GENIUS .X ± 0.30

UNIT / mm SCALE 1 : 1 .XX ± 0.20

DATE .XXX ± ANG ±

煜倫股份有限公司

www.morethanall.com

SIZE A4 PROJECTION

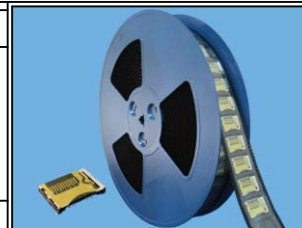

ORDER INFORMATION

MHC-W21R-601-LF
SERIES LEADFREE
SD/MMC 6 IN 1
REEL
POST 21.00mm
90°SMT

DESCRIPTION:

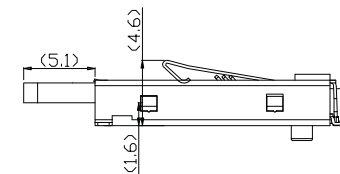
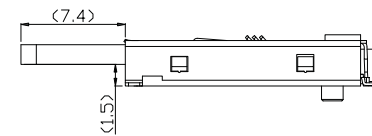
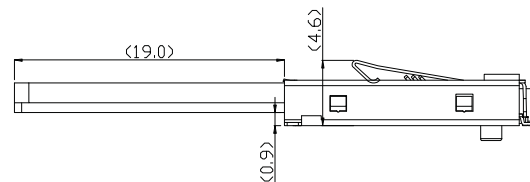
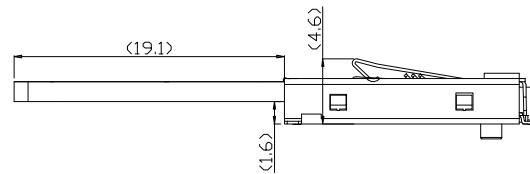
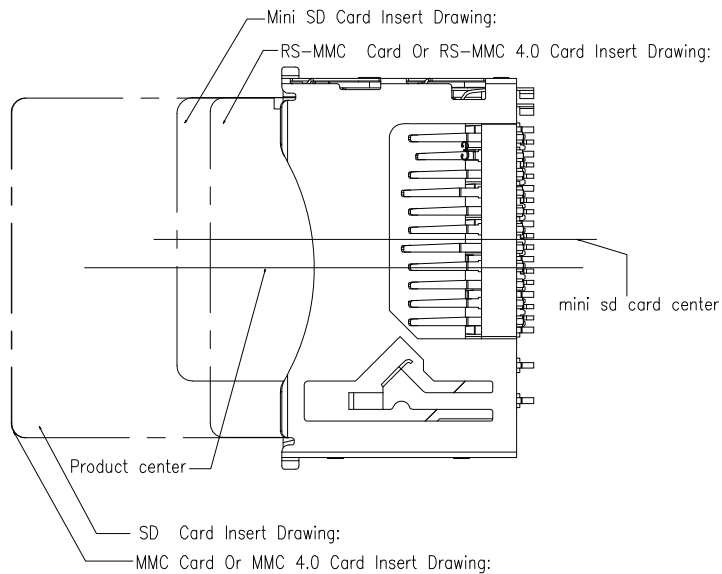

MORETHANALL
 PCB CONNECTORS
 Cable ASSEMBLIES

煜倫股份有限公司

www.morethanall.com

RoHS Compliant

DRAWING BY CY

CHECKED BY GENIUS

UNIT / mm

SCALE 1 : 1

DATE

SIZE A4

TOLERANCES ARE

X. ± 0.50

.X ± 0.30

.XX ± 0.20

.XXX ±

ANG ±

PJECTION

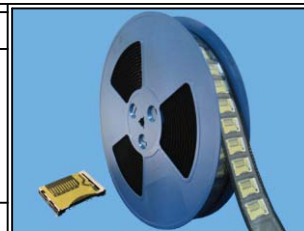

ORDER INFORMATION

MHC-W21R-601-LF
 SERIES REEL POST 21.00mm 90°SMT
 LEADFREE
 SD/MMC 6 IN 1

DESCRIPTION:

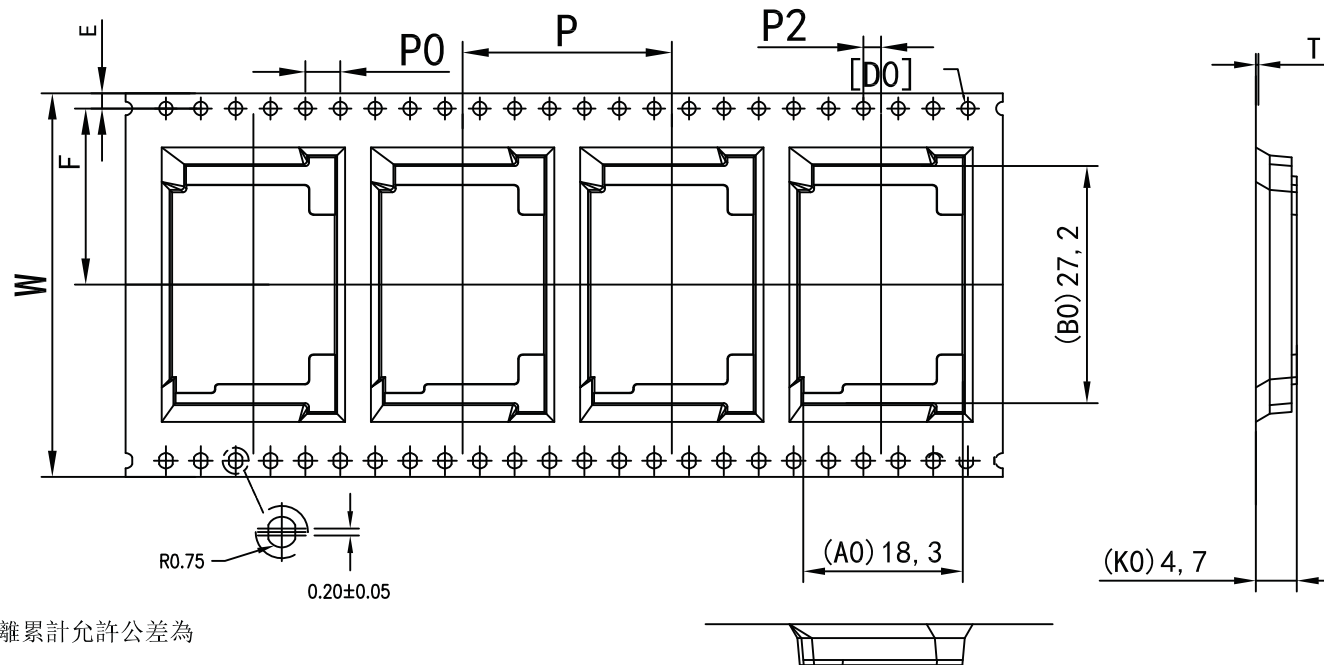

1. 上圓孔十個孔距離累計允許公差為 ±0.2mm
2. 帶長250mm內容許彎曲度1mm
3. 所有尺寸定義依循EIA-481-2A系準則定義之設計
4. 材料：黑色PS
5. 材料厚度：0.40±0.05mm
6. 13寸的卷盤包裝米數：12.768M, 包裝粒數：500PCS 前預留20PCS後預留12PCS

注：測量工具

Ⓐ 二次元投影儀 B 卡尺 Ⓒ 高度尺

W	T	A0	A1	B0	B1	K0	K1	項目
44.00 ^{+0.3} _{-0.3}	0.40 ^{+0.05} _{-0.05}	18.30 ^{+0.1} _{-0.1}	0.00 ^{+0.1} _{-0.1}	27.20 ^{+0.15} _{-0.10}	0.00 ^{+0.15} _{-0.10}	4.70 ^{+0.15} _{-0.15}	0.00 ^{+0.15} _{-0.15}	尺寸
P	F	E	D0	D1	P0	P2		項目
24.00 ^{+0.1} _{-0.1}	20.2 ^{+0.1} _{-0.1}	1.75 ^{+0.1} _{-0.1}	1.50 ^{+0.1} _{-0.0}	0.00 ^{+0.0} _{-0.0}	4.00 ^{+0.1} _{-0.1}	2.00 ^{+0.1} _{-0.1}		尺寸

RoHS Compliant

TOLERANCES ARE

MORETHANALL
PCB CONNECTORS
Cable ASSEMBLIES

煜倫股份有限公司

www.morethanall.com

DRAWING BY CY

CHECKED BY GENIUS

UNIT / mm SCALE 1 : 1

DATE

SIZE A4

X, ± 0.50

.X, ± 0.30

.XX, ± 0.20

.XXX, ±

ANG ±

PPOJECTION

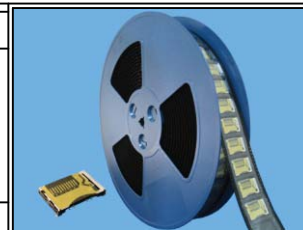

ORDER INFORMATION

MHC-W21R-601-LF
SERIES | REEL | POST 21.00mm
LEADFREE
SD/MMC 6 IN 1
90°SMT

DESCRIPTION: