

SPECIFICATION
MATERIAL
 Insulator: Thermoplastic
 Contacts: Copper Alloy
 Shell: Steel
 O-ring: Silicone
 Sealant: Epoxy-Resin
 Rivet: Copper Alloy

CONTACT PLATING
 Underplate :50u"~150u" Nickel
 Contact Area :1u"~30u" Selective Gold
 Rivet :50u"~100u" Nickel

ELECTRICAL
 Operation Voltage :250 VAC Max
 Current Rating :3 Amps Max
 Contact Resistance :15 Mohms Min 500 VDA
 Dielectric Withstanding Voltage 1000 VAC/Minute
 Temperature Range :-55°C TO +105°C

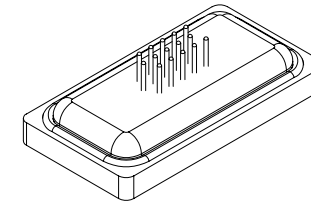

PIN	A	B	C	D	E	F	W	Y
15	39.50	31.00	25.00	16.34	1.145	2.29	25.20	20
26	48.00	39.30	33.32	24.66	1.145	2.29	33.50	28.30
44	61.50	53.20	47.04	38.38	1.145	2.29	47.20	42.00
62	77.80	69.50	63.50	54.84	1.205	2.41	63.70	58.50

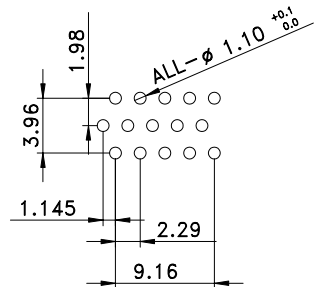

Recommended P.C.B Layout
 For 15PIN TOLERANCE: $\pm 0.05\text{mm}$

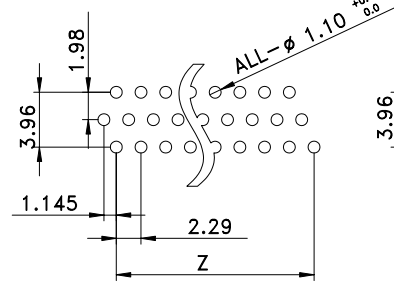

Recommended P.C.B Layout
 For 26PIN $Z=18.32$
 For 44PIN $Z=32.06$
 TOLERANCE: $\pm 0.05\text{mm}$

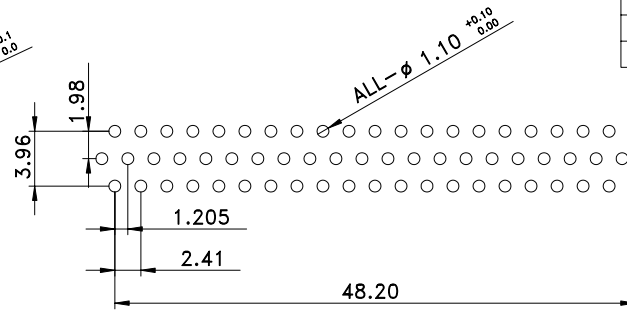

Recommended P.C.B Layout
 For 62PIN TOLERANCE: $\pm 0.05\text{mm}$

RoHS Compliant

TOLERANCES ARE

MORETHANALL
 PCB CONNECTORS
 Cable ASSEMBLIES

DRAWING BY CY

CHECKED BY GENIUS

UNIT / mm

SCALE 1 : 1

DATE

SIZE A4

PPOJECTION

X, \pm
 X, \pm
 .XX \pm
 .XXX \pm
 ANG \pm



ORDER INFORMATION

WPHD-SDN-xx-LF

SERIES LEADFREE
 15~62WAY
 NUT
 DIP 180°
 FEMALE

煜倫股份有限公司

www.morethanall.com

DESCRIPTION: Water Proof HIGH DENSITY D-SUB(DIP180° FEMALE)