

Technical Data:

Material:

- Solder Pin: Brass with Tin plated
- Insulator body(housing): Polyamide(Glass filled)  
(UL94V-0)

Electrical

- Voltage rating: 300VAC
- Current rating: 15A
- Insulation resistance: 5000MΩ/1000V
- Withstanding Voltage: AC1500V(1min)

Mechanical:

- Using temperature Range: -30°C to +105°C
- Soldering temperature: +250°C/5seconds Max.

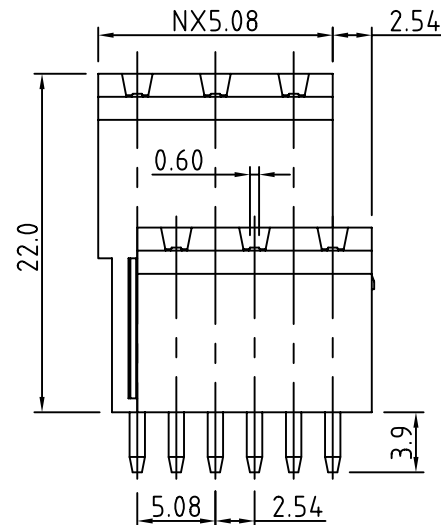
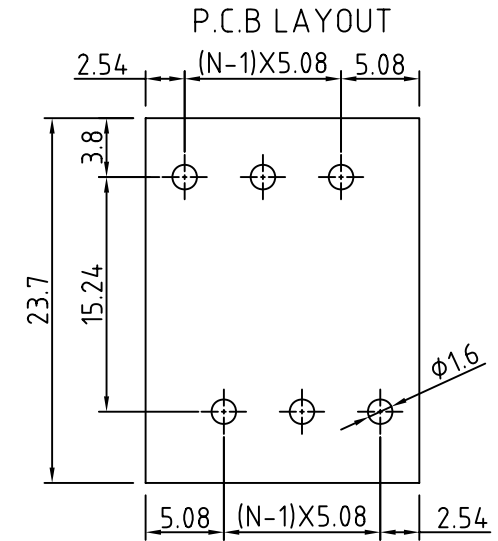
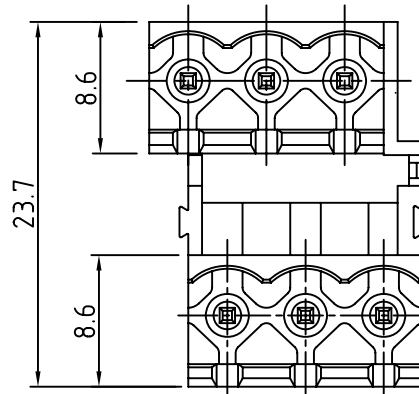

N= Number of contacts

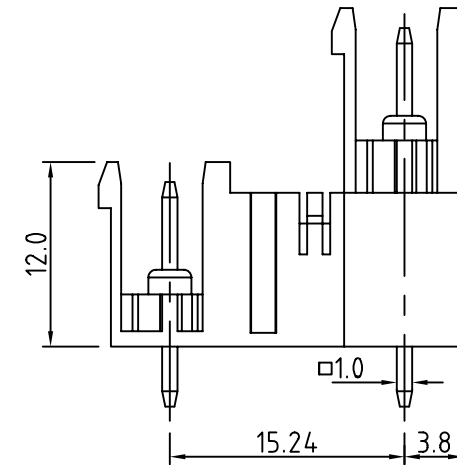

RoHS Compliant

TOLERANCES ARE

**MORETHANALL**  
PCB CONNECTORS  
Cable ASSEMBLIES

DRAWING BY CY

X.±

CHECKED BY GENIUS

.X±

UNIT / mm

SCALE 1 : 1

.XXX±

DATE

ANG±

煜倫股份有限公司

www.morethanall.com

SIZE A4

P PROJECTION

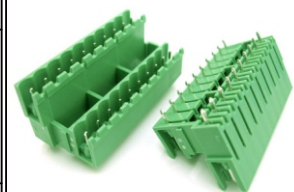

ORDER INFORMATION

TBH051B1-PDR-xx-LF

SERIES

LEADFREE

POS PER ROW

02:02 WAY

24:24 WAY

MALE

DIP 180°

R TYPE FOOT

DESCRIPTION: