

Recommended P.C.B. Layout

(Tolerance:0.05mm)

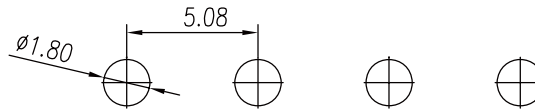

Specifications

- Current Rating: 7.9Amp
- Insulation Resistance: 5000M Ω Min.
- Dielectric Withstanding: 1500V AC/DC
- Contact Resistance: 20m Ω Max.
- Operating Temperature: -55°C to +125°C

MATERIAL:

- HOUSING: LCP. FLAMMABILITY UL94-V0
OR OTHER HIGH LEVEL PLASTIC, COLOR:BLACK.
- Contact: Brass Δ

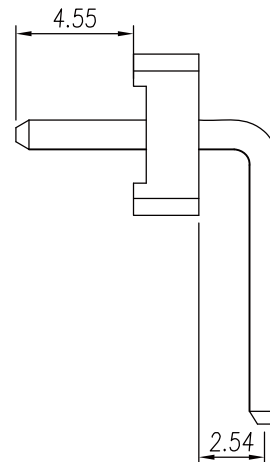
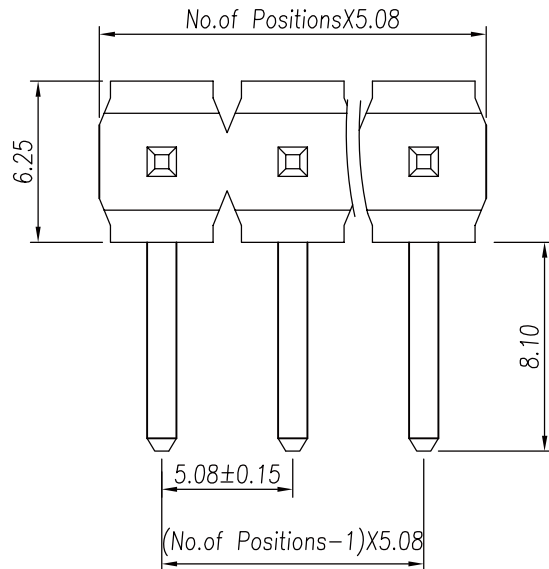

RoHS Compliant

TOLERANCES ARE

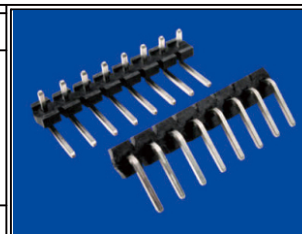

ORDER INFORMATION

H51-RH2525081045-1Xxx-LF

SERIES	1X02:02WAY	LEADFREE
DIP 90°	1X20:20WAY	
HIGH	DIP 4.55mm	
BASE 2.54mm	CONTACT 8.10mm	
	R/A 2.54mm	

MORETHANALL
PCB CONNECTORS
Cable ASSEMBLIES

煜倫股份有限公司

www.morethanall.com

DRAWING BY CY

CHECKED BY GENIUS

UNIT / mm

SCALE 1 : 1

DATE

SIZE A4

X. \pm
.X \pm
.XX \pm 0.20
.XXX \pm 0.20
ANG \pm

P PROJECTION \oplus \ominus

DESCRIPTION: 5.08 PIN HEADER SINGLE ROW R/A TYPE CONNECTOR