

**P.C.B. LAYOUT**

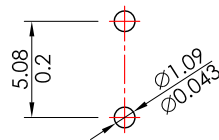

	POS.1	POS.2
Model No.		
	OFF	(ON)
Term. Com.	OPEN	1-3
Schematic		

**SPECIFICATION**

**Rating:** 0.4VA Max. @20V Max.(AC or DC)  
**Contact resistance:** 20mΩ Max. Initial @2-4V DC  
 100mA for both Silver and Gold plated contacts.  
**Insulation resistance:** 1,000MΩ Min.  
**Withstand voltage:** 1,000V RMS @ sea level.  
**Operating temperature:** -30°C ~ +85°C.  
**Mechanical life:** 50,000 Cycles.  
**Soldering temperature:** 250°C Max. for 3 seconds.  
**Soldering time:** 1 time only.  
**Waterproof level:** IP67.  
**Note:** Please do not scale the drawing comparing to real product and kindly measure the size of real product.

**MATERIAL**

**Case & bushing:** Glass filled Nylon 66, flame retardand, heat stabilized.(UL-94V-0)  
**Plunger:** Thermoplastic polyester (UL-94V-0), with internal O-ring seal.  
**Switch support:** Brass or Steel electro Tin plated.  
**Contact:** Copper alloy, Gold plated.

保存注意事項：

**Precautions for preservation:**

- 此產品為鍍銀或鍍金產品，裸露在空氣中極易氧化，會造成冷焊或焊接不良。建議拆封後，未使用完的開關務必放入袋內，並置入乾燥劑後密封袋口，以防氧化。  
 This is a silver-plated or gold-plated product, which can be easily oxidized when exposed to air that may cause cold welding or poor welding. We recommend that after unpacking, the unused switch must be preserved into a sealed bag with desiccant to prevent oxidation.
- 若產品拆封後，客戶未盡妥善保存之責，造成產品氧化，我司無法負保固責任。  
 After the product is unpacked, if the customer fails to properly preserve the product, causing the product to oxidize, our company cannot be held responsible for the warranty.

**RoHS Compliant**



煜倫股份有限公司

www.morethanall.com

DRAWING BY CY	
CHECKED BY GENIUS	
UNIT / mm	SCALE 1 : 1
DATE	
SIZE A4	PPOJECTION

TOLERANCES ARE

X. ±
.X ±
.XX ±
.XXX ±
ANG ±

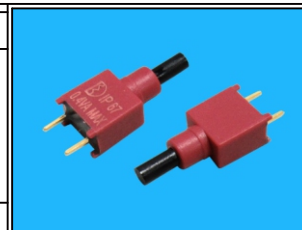

**ORDER INFORMATION**

SPSW08-D188-1X02-LF  
 SERIES | LEADFREE  
 02 WAY  
 HIGH 18.85mm  
 DIP 180°

DESCRIPTION: