

RECOMMENDED P.C.B LAYOUT

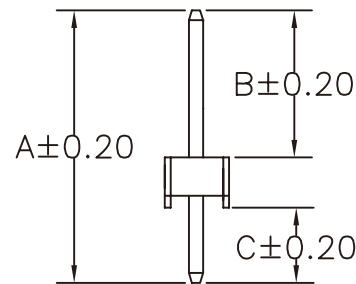
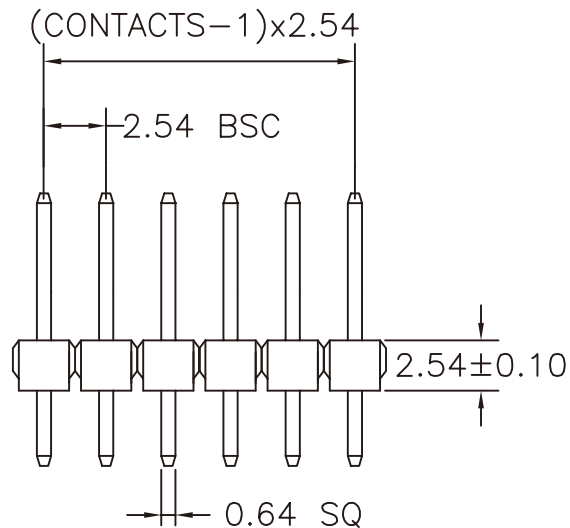

A: 11.54 mm B: 6.00 mm C: 3.00 mm

CONTACTS	1X26
1X2	1X27
1X3	1X28
1X4	1X29
1X5	1X30
1X6	1X31
1X7	1X32
1X8	1X33
1X9	1X34
1X10	1X35
1X11	1X36
1X12	1X37
1X13	1X38
1X14	1X39
1X15	1X40
1X16	1X41
1X17	1X42
1X18	1X43
1X19	1X44
1X20	1X45
1X21	1X46
1X22	1X47
1X23	1X48
1X24	1X49
1X25	1X50

**MATERIAL**  
 HOUSING : PBT,UL94V-0  
 CONTACT : COPPER ALLOYS  
 PLATED : GOLD FALSH  
 COLOR : BLACK

**SPECIFICATION**  
 CURRENT: 3A  
 OPERATING TEMPERATURE: -55°C TO +105°C  
 CONTACT RESISTANCE : 20 MILLIOHMS MAX  
 INSULATION RESISTANCE : 1000 MEGAOHMS MIN  
 WITHSTANDING VOLTAGE : AC 1000V RMS

RoHS Compliant

TOLERANCES ARE

**MORETHANALL**  
 PCB CONNECTORS  
 Cable ASSEMBLIES  
 煜倫股份有限公司

DRAWING BY CY  
 CHECKED BY GENIUS  
 UNIT / mm SCALE 1 : 1  
 DATE  
 SIZE A4 PPROJECTION

X.  $\pm$   
 .X  $\pm 0.20$   
 .XX  $\pm 0.10$   
 .XXX  $\pm$   
 ANG  $\pm$

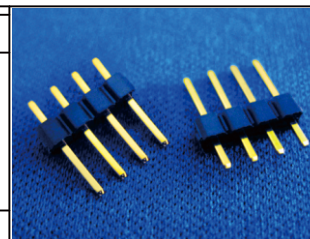

ORDER INFORMATION

H-D-1Xxx-LF  
 SERIES LEADFREE  
 1X02:02WAY  
 1X50:50WAY  
 DIP 180°

DESCRIPTION:

www.morethanall.com