

(2 to 6 circuits)

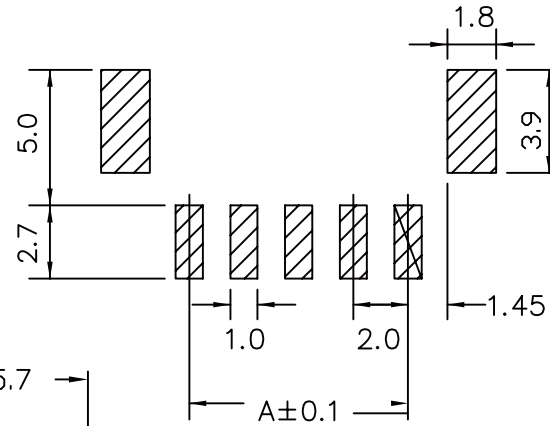

RECOMMENDED P.C.BOARD LAYOUT DIMM.

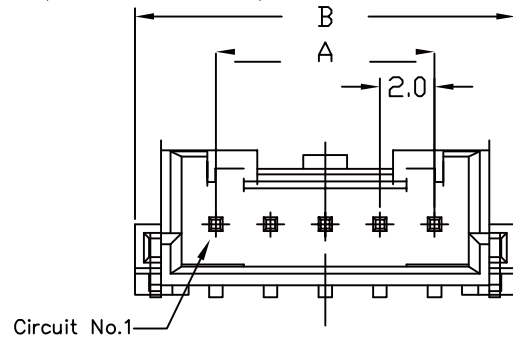
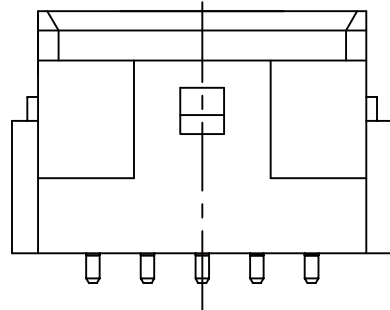
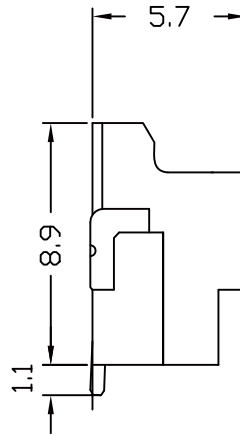
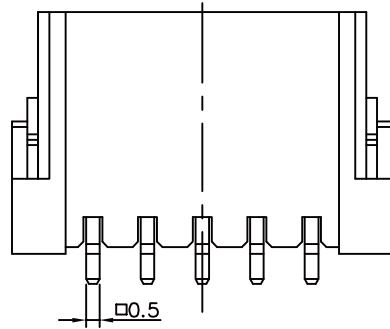

Specifications

Current Rating: 3A AC/ DC (Max)AWG#22
 Voltage Rating: 250V AC/ DC
 Temperature Range: -25°C ~ + 85°C
 Contact Resistance: 20mΩ Max
 Insulation Resistance: 1000MΩ Min
 Withstanding Voltage:800V AC/Minute
 Pin : Brass/ Tin-plated
 Wafer Material: Nylon 6T,UL94V-0,natural
 Solder tab:Brass/Tin-plated

Poles	Dimension mm (in.)		Part No.	Note.
	A	B		
2	2.0(0.079)	8.0(0.315)	PA-WX-02	
3	4.0(0.157)	10.0(0.394)	PA-WX-03	
4	6.0(0.236)	12.0(0.472)	PA-WX-04	
5	8.0(0.315)	14.0(0.551)	PA-WX-05	
6	10.0(0.394)	16.0(0.630)	PA-WX-06	

RoHS Compliant

TOLERANCES ARE

MORETHANALL
 PCB CONNECTORS
 Cable ASSEMBLIES

煜倫股份有限公司

www.morethanall.com

DRAWING BY CY

CHECKED BY GENIUS

UNIT/ mm SCALE 1:1

DATE

SIZE A4

X, ±
 .X ±
 .XX ±
 .XXX ±
 ANG ±

PJECTION

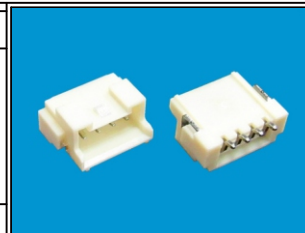

ORDER INFORMATION

PA-WX-xx-LF
 SERIES | LEADFREE
 | 02-15WAY
 | NON POST
 | 90°SMT

DESCRIPTION: 2.0mm Wire-to-Board Header SMD 90° Type

(7 to 9 circuits)

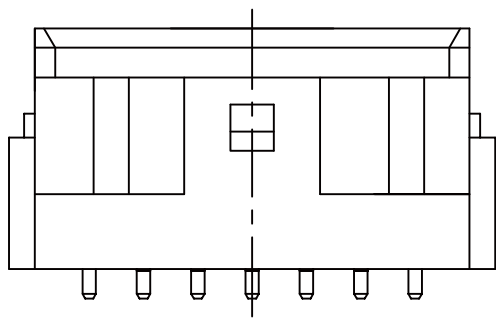
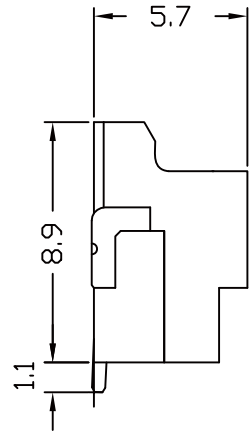
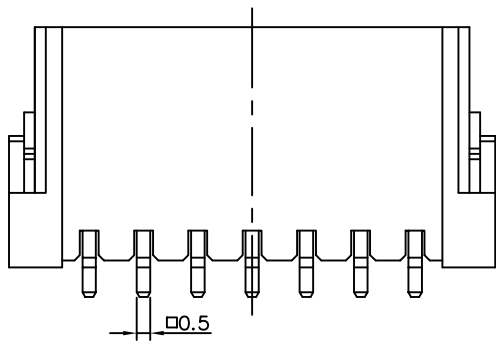
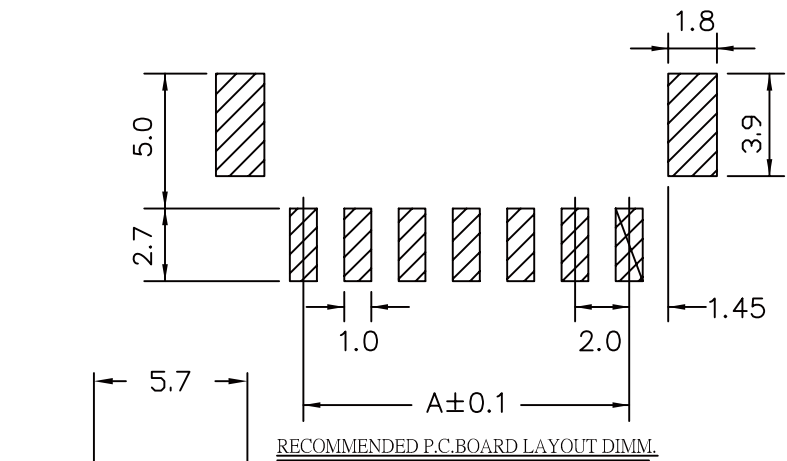
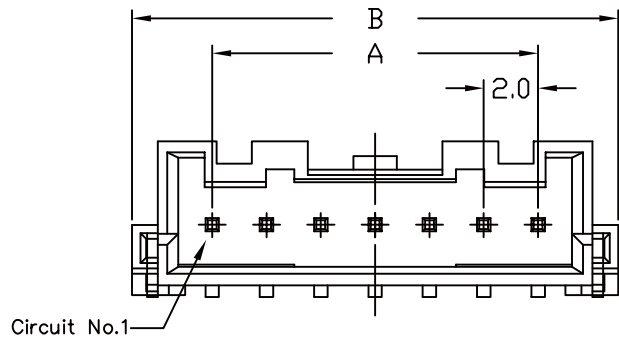

Specifications

Current Rating: 3A AC/ DC (Max)AWG#22
 Voltage Rating: 250V AC/ DC
 Temperature Range: -25°C ~ + 85°C
 Contact Resistance: 20mΩ Max
 Insulation Resistance: 1000MΩ Min
 Withstanding Voltage:800V AC/Minute
 Pin : Brass/ Tin-plated
 Wafer Material: Nylon 6T,UL94V-0,natural
 Solder tab:Brass/Tin-plated

Poles	Dimension mm (in.)		Part No.	Note.
	A	B		
7	12.0(0.472)	18.0(0.709)	PA-WX-07	
8	14.0(0.551)	20.0(0.787)	PA-WX-08	
9	16.0(0.630)	22.0(0.866)	PA-WX-09	

RoHS Compliant

TOLERANCES ARE



煜倫股份有限公司

www.morethanall.com

DRAWING BY CY

CHECKED BY GENIUS

UNIT/ mm SCALE 1:1

DATE

SIZE A4

X. ±
 .X ±
 .XX ±
 .XXX ±
 ANG ±

PJECTION

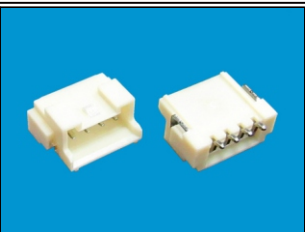

ORDER INFORMATION

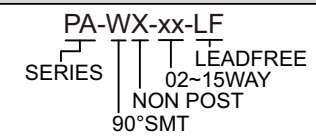

DESCRIPTION: 2.0mm Wire-to-Board Header SMD 90° Type

(10 to 15 circuits)

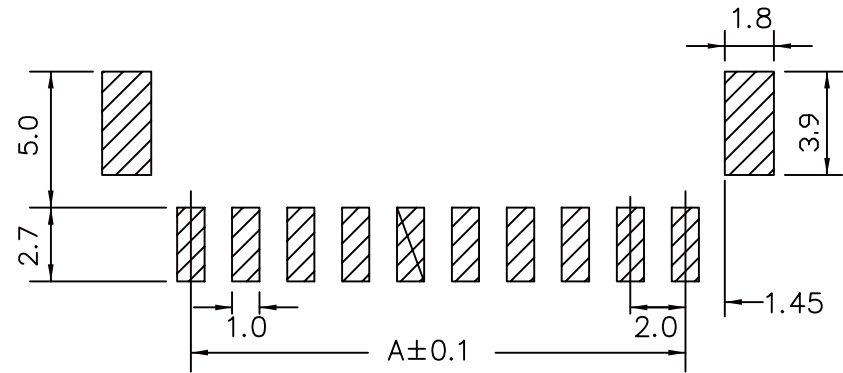
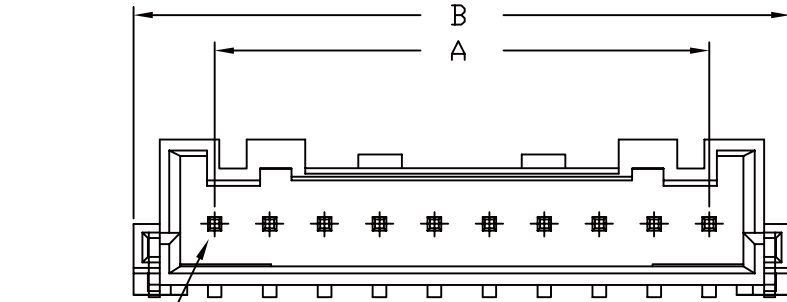

RECOMMENDED P.C.BOARD LAYOUT DIMM.

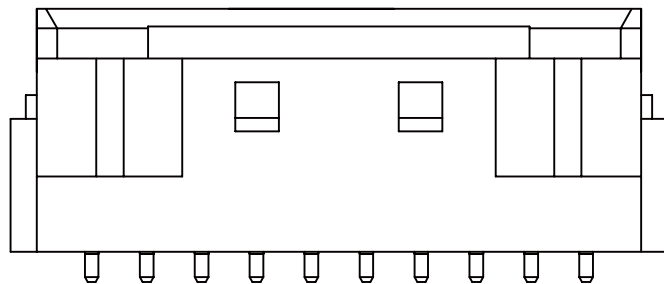
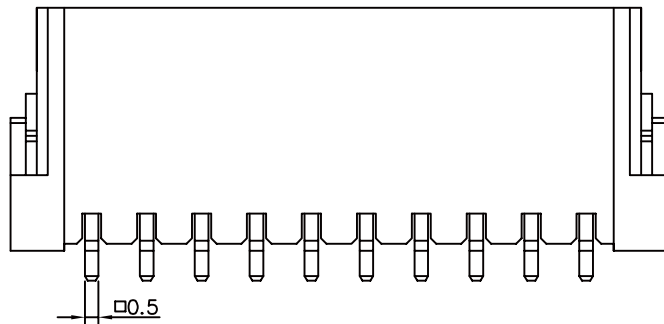
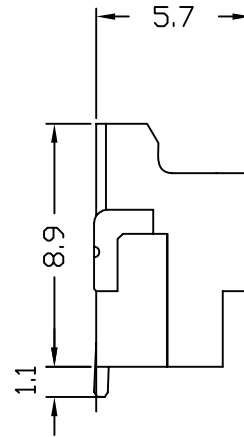

Specifications

Current Rating: 3A AC/ DC (Max)AWG#22
 Voltage Rating: 250V AC/ DC
 Temperature Range: -25°C ~ + 85°C
 Contact Resistance: 20mΩ Max
 Insulation Resistance: 1000MΩ Min
 Withstanding Voltage:800V AC/Minute
 Pin : Brass/ Tin-plated
 Wafer Material: Nylon 6T,UL94V-0,natural
 Solder tab:Brass/Tin-plated

Poles	Dimension mm (in.)		Part No.	Note.
	A	B		
10	18.0(0.709)	24.0(0.945)	PA-WX-10	
11	20.0(0.787)	26.0(1.024)	PA-WX-11	
12	22.0(0.866)	28.0(1.102)	PA-WX-12	
13	24.0(0.945)	30.0(1.181)	PA-WX-13	
14	26.0(1.024)	32.0(1.260)	PA-WX-14	
15	28.0(1.102)	34.0(1.338)	PA-WX-15	

RoHS Compliant

TOLERANCES ARE

MORETHANALL
 PCB CONNECTORS
 Cable ASSEMBLIES

煜倫股份有限公司

www.morethanall.com

DRAWING BY CY

CHECKED BY GENIUS

UNIT/ mm SCALE 1:1

DATE

SIZE A4

X, ±
 .X ±
 .XX ±
 .XXX ±
 ANG ±

PJECTION

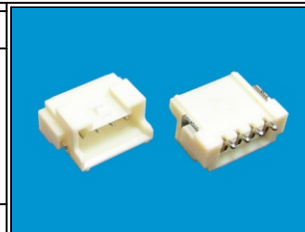

ORDER INFORMATION

PA-WX-xx-LF
 SERIES | LEADFREE
 | 02~15WAY
 | NON POST
 | 90°SMT

DESCRIPTION: 2.0mm Wire-to-Board Header SMD 90° Type