

• **MATERIALS:(RoHS Compliant)**

Housing: Plastic Thermoplastic
 P.B.T UL94V-0 Black
 Contacts: Phosphor Bronze Gold
 Selective Plated
 Front Shell: Steel Nickel Plated Over Copper

• **ELECTRICAL CHARACTERISTICS:**

Contact Current Rating: 1 Amp
 Dielectric Withstanding Voltage: 500V AC
 Insulation Resistance: >500MΩ/Min
 Contact Resistance: 35mΩ/Max
 Operation Temperature: -55°C ~ +105°C

Entry Hole
 8.57-

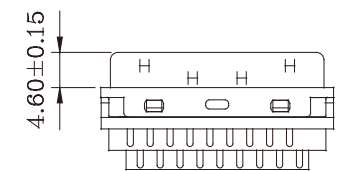
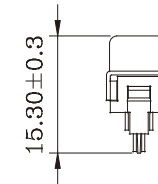
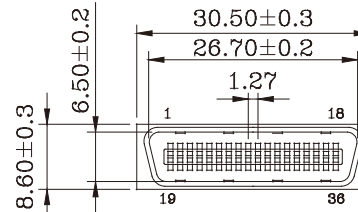
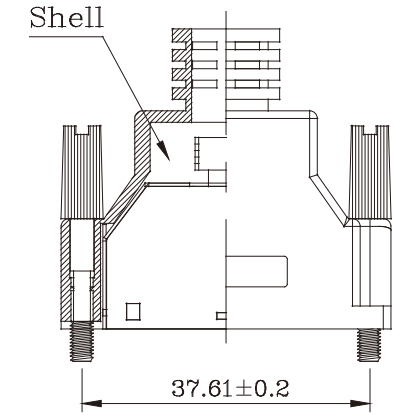
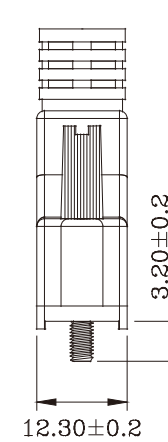
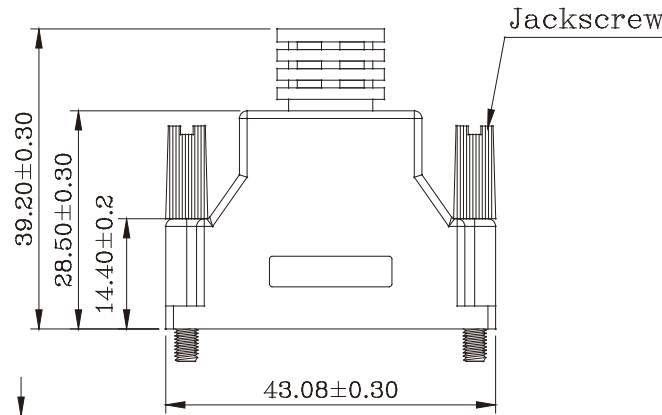
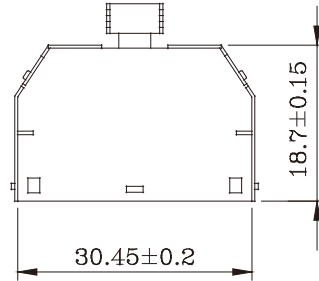
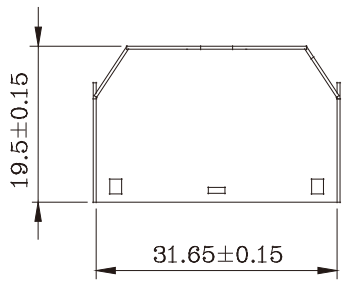
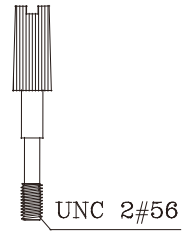
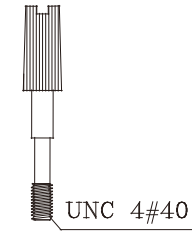
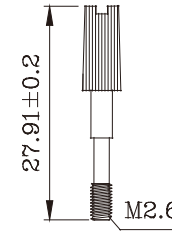
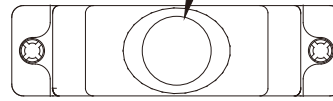

RoHS Compliant

TOLERANCES ARE

MORETHANALL
 PCB CONNECTORS
 Cable ASSEMBLIES

DRAWING BY CY
 CHECKED BY GENIUS
 UNIT / mm SCALE 1:1
 DATE

X.±
 .X±
 .XX±
 .XXX±
 ANG±



ORDER INFORMATION

HPC-PSMBK-036-LF
 SERIES | 36 WAY | LEADFREE
 BLACK COVER
 SOLDER
 MALE

煜倫股份有限公司

www.morethanall.com

SIZE A4 PPROJECTION

DESCRIPTION: 1.27mm(.050") Series
 36Pos Plastic Hood With Jackscrews