

PIN	SIGNAL NAME	
1	10	VBUS
2	11	D-
3	12	D+
4	13	GND
5	14	StdA_SSRX-
6	15	StdA_SSRX+
7	16	GND-DRAIN
8	17	StdA_SSTX-
9	18	StdA_SSTX+

DATE	CODE	DESCRIPTION
21	13	4
Thursday		
13 Weeks		
Year		

NOTES:

***Material**

Housing: PBT, UL94 V-0;
 Baffle : Nylon66, UL94 V-0;
 Contacts(4Pin): Phosphor Bronze
 Contacts(5Pin): Brass
 Plating: Au Plating On Contact Area;
 Sn(100u"Min.) Plating On Solder Tail.
 Ni(50u"Min.) Underplating Overall.
 Shell(Front): Brass; Ni(40u"Min.) Plating Overall
 Shell(In)&Shell(Back): Stainless Steel, No Plating

***Mechanical**

Insertion Force: 35N Max.
 Withdrawal Force: 10N Min.
 Durability: 1500 Cycles.

***Electrical Specification**

Current Rating: 1.8A(Only Pin1,4,10,13), 0.25A For Other Pin
 Contact Resistance: 30mΩ Max.
 Insulation Resistance: 100MΩ Min.
 Dielectric Withstanding Voltage: 100V AC Min.

***Environmental**

Operating Temperature: -55°C To +85°C

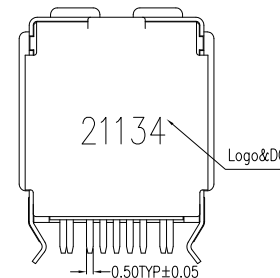
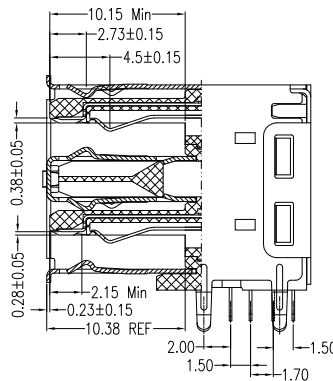
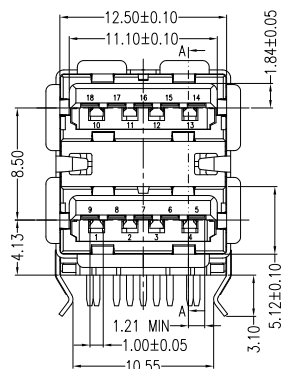
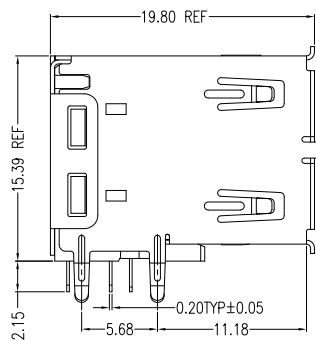

SECTION A-A

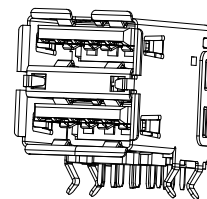
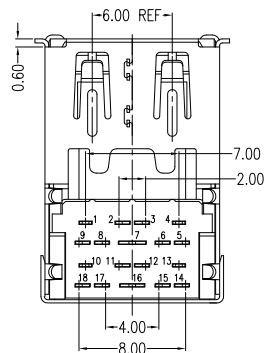
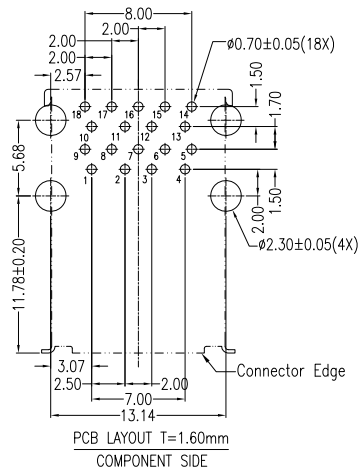

RoHS Compliant

TOLERANCES ARE



煜倫股份有限公司

www.morethanall.com

DRAWING BY CY

CHECKED BY GENIUS

UNIT / mm

SCALE 1 : 1

DATE

SIZE A4

PPOJECTION

X, ±
 .X ± 0.35
 .XX ± 0.25
 .XXX ± 0.15
 ANG ± 3°



ORDER INFORMATION

USB1-FRX11BL-9A-LF

SERIES | | | | LEADFREE
 FEMALE | | | | 9 PIN A TYPE
 | | | | BLUE
 | | | | 11.18mm
 | | | | NON SPRING
 | | | | DIP 90°

DESCRIPTION: Double USB 3.2 Gen1 A Type Receptac