

P.C. Board Layout (Coaxial)

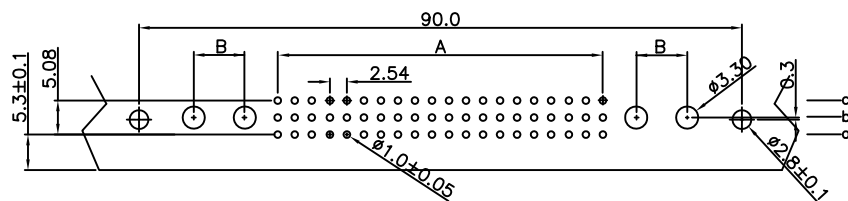

P.C. Board Layout (Power)

Dimension	
A	(2.54 x No of Contact)/3-2.54
B	(7.62 x No of Coaxial)/2-7.62

Material:
Housing: 30% Glass filled PBT UL94V-0.
Contacts: Phosphor Bronze.
Coaxial or Power: Cu Alloy.

Electrical Characteristics:
Current Rating: 2 AMP.
Dielectric Withstanding Voltage: AC 1000V For 1 minute.
Insulator Resistance: 1000MΩ min. at DC 500V.
Contact Resistance: 30mΩ max. at DC 100mA.
Operating Temperature: -55°C ~ +105°C .
* **RoHS Compliant**

RoHS Compliant

TOLERANCES ARE

MORETHANALL
PCB CONNECTORS
Cable ASSEMBLIES

煜倫股份有限公司

www.morethanall.com

DRAWING BY CY

CHECKED BY GENIUS

UNIT / mm SCALE 1 : 1

DATE

SIZE A4

PJECTION

X, ±
.X ±
.XX ±
.XXX ±
ANG ±

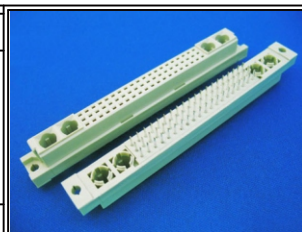

ORDER INFORMATION

UM-SD04-60+4-LF
SERIES LEADFREE
60+4 WAY
4.0mm LENGTH
DIP 180°
FEMALE

DESCRIPTION: