

RECOMMENDED P.C. BOARD HOLE DIMM.

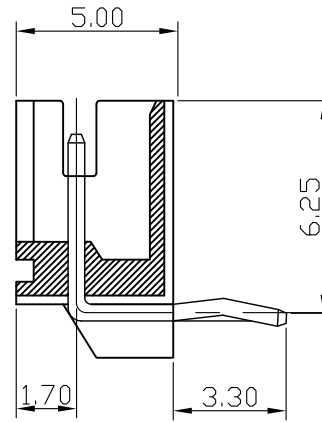

## Specifications

### Electrical

Voltage Rating: 100V(AC)

Current Rating: 2A

Contact Resistance: 20mΩ max.

Dielectric Withstandeing Voltage: 800V AC/1min.

Insulation Resistance: 1000MΩ min.

### Material

Circuits: 2~16

Insulator: Nylon 66 UL 94V-0

Color: White or Natural

Contact: Brass 0.50mm(0.20") Square Pin

Plating: Tin or Gold Plated

Temperature Range: -40° C~+85° C

Applicable PC Board Thickness: 0.8 to 1.6mm

Poles	Dimension mm (in.)		Part No.	Note.
	A	B		
2	2.0(0.079)	6.04(0.237)	PH-RG-02	
3	4.0(0.157)	8.04(0.316)	PH-RG-03	
4	6.0(0.236)	10.04(0.395)	PH-RG-04	
5	8.0(0.315)	12.04(0.473)	PH-RG-05	
6	10.0(0.394)	14.06(0.473)	PH-RG-06	
7	12.0(0.472)	16.06(0.631)	PH-RG-07	
8	14.0(0.551)	18.08(0.711)	PH-RG-08	
9	16.0(0.630)	20.08(0.790)	PH-RG-09	
10	18.0(0.709)	22.10(0.870)	PH-RG-10	
11	20.0(0.787)	24.10(0.949)	PH-RG-11	
12	22.0(0.886)	26.12(1.027)	PH-RG-12	
13	24.0(0.945)	28.12(1.106)	PH-RG-13	
14	26.0(1.024)	30.14(1.203)	PH-RG-14	
15	28.0(1.102)	32.14(1.283)	PH-RG-15	
16	30.0(1.181)	34.14(1.363)	PH-RG-16	

RoHS Compliant

TOLERANCES ARE

**MORETHANALL**  
PCB CONNECTORS  
Cable ASSEMBLIES

DRAWING BY CY

CHECKED BY GENIUS

UNIT/mm

SCALE 1:1

DATE

SIZE A4

PJECTION

X. ±  
.X ±  
.XX ±  
.XXX ±  
ANG ±

煜倫股份有限公司

www.morethanall.com

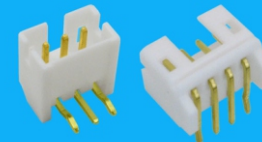

### ORDER INFORMATION

PH-RG-xx-LF  
SERIES | LEADFREE  
02-16WAY  
GOLD  
DIP 90°

DESCRIPTION: 2.0mm Wire-to-Board Header DIP 90° Type