

**Features:**

- 2 ~ 12 circuits available
- Material: LCP
- Tin-plated brass pin

**Specification:**

- Current rating: 5A AC, DC
- Voltage rating: 250V AC, DC
- Contact resistance: 10mΩ Max.
- Dielectric withstanding voltage: 1500V AC/minute
- Ambient temperature range: -25°C ~ 85°C

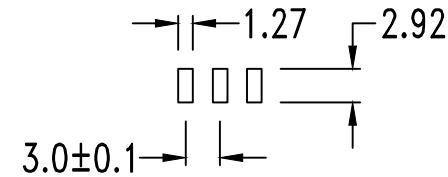
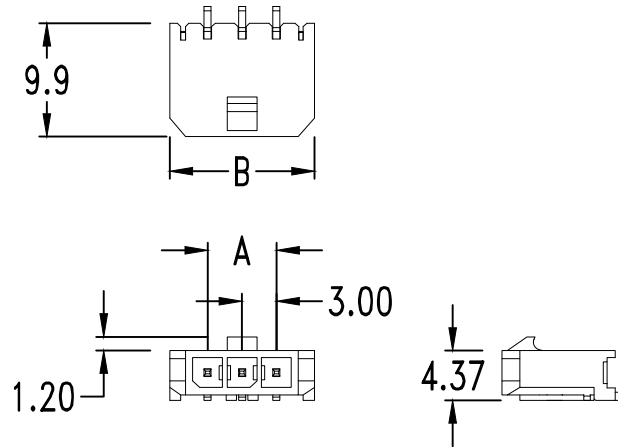

PCB Layout: Component side

&& xx = 02 ~ 12

**Dimensional Information**

Circuits	Dim. A	Dim. B	Circuits	Dim. A	Dim. B	Circuits	Dim. A	Dim. B	Circuits	Dim. A	Dim. B	Circuits	Dim. A	Dim. B	Circuits	Dim. A	Dim. B
2	3.0	9.65	4	9.0	15.65	6	15.0	21.65	8	21.0	27.65	10	27.0	33.65	12	33.0	39.65
3	6.0	12.65	5	12.0	18.65	7	18.0	24.65	9	24.0	30.65	11	30.0	36.65			

**RoHS Compliant**

TOLERANCES ARE

**MORETHANALL**  
PCB CONNECTORS  
Cable ASSEMBLIES

DRAWING BY CY

CHECKED BY GENIUS

UNIT / mm SCALE 1 : 1

DATE

SIZE A4 PROJECTION

X, ±  
.X ± 0.25  
.XX ± 0.15  
.XXX ± 0.05  
ANG ±

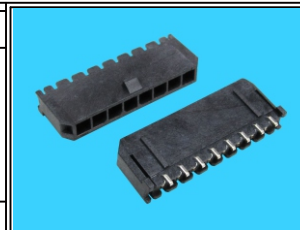

**ORDER INFORMATION**

MIF-PWX-1Xxx-LF  
SERIES | LEADFREE  
MALE | 1X02:02 WAY  
90°SMT | 1X12:12 WAY  
NON EAR

**煜倫股份有限公司**

www.morethanall.com

DESCRIPTION: