

Technical Data:

Material:

- Solder Pin: Brass with Tin plated
- Insulator body(housing): Polyamide(Glass filled)
(UL94V-0)

Electrical

- Voltage rating: 300VAC
- Current rating: 15A
- Insulation resistance: 5000M Ω /1000V
- Withstanding Voltage: AC1500V(1min)

Mechanical:

- Using temperature Range: -30°C to +105°C
- Soldering temperature:+250°C/5seconds Max.

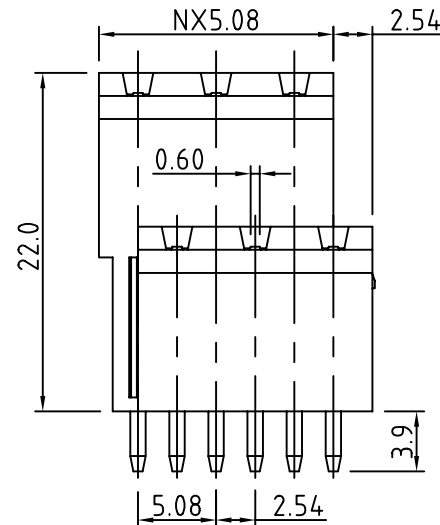
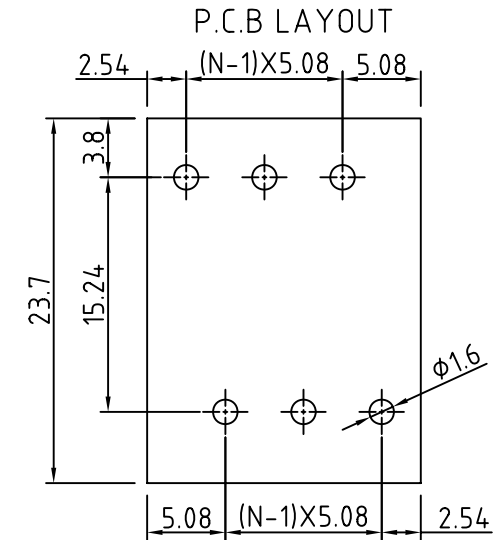
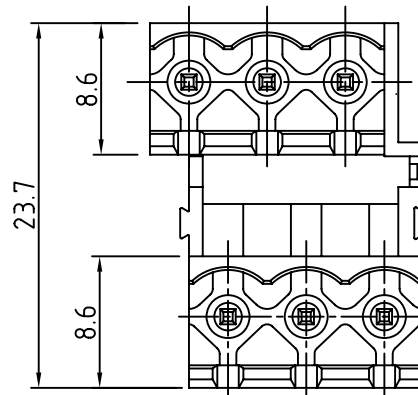

N= Number of contacts

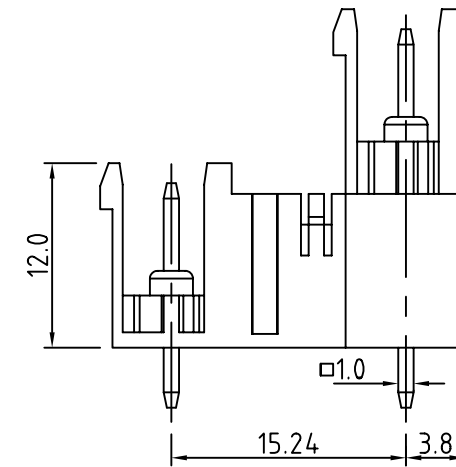

RoHS Compliant

TOLERANCES ARE

MORETHANALL
 PCB CONNECTORS
 Cable ASSEMBLIES

DRAWING BY CY

X, \pm

CHECKED BY GENIUS

.X, \pm

UNIT / mm

SCALE 1 : 1

.XX, \pm

DATE

.XXX, \pm

ANG, \pm

SIZE A4

PPOJECTION

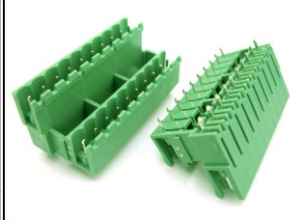

ORDER INFORMATION

TBH051B1-PDR-xx-LF

SERIES

LEADFREE
 02 PER ROW:04 PIN
 24 PER ROW:48 PIN
 MALE R TYPE FOOT
 DIP 180°

煜倫股份有限公司

www.morethanall.com

DESCRIPTION: