

Note:

Material:

Insert: Thermoplastic, UL94V-0, Black

Contact: Pre-tinned Phosphor Bronze

Make kinks on the first and end terminal

When the locking mechanism is in the open position dimension D is 0.20~0.30 mm

When the locking mechanism is in the closed position dimension D is 0.000 mm

1.No.of circuits.(08~20)

A=2.54(.100")mm *No.of Spaces

B=A+7.00(.276")mm

C=A+16.20(.638")mm

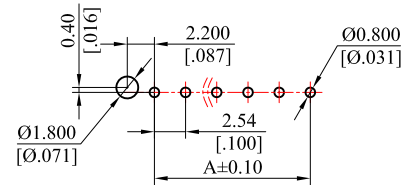

Recommended PCB Layout

RoHS Compliant

TOLERANCES ARE

MORETHANALL
PCB CONNECTORS
Cable ASSEMBLIES

DRAWING BY CY

X, ±

CHECKED BY GENIUS

.X ± 0.30

UNIT / mm

SCALE 1 : 1

.XX ± 0.20

DATE

.XXX ± 0.10

ANG ±

SIZE A4

PPOJECTION

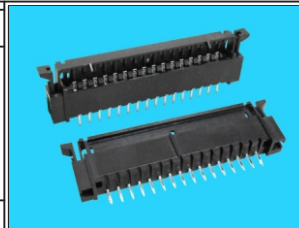

ORDER INFORMATION

FPC-DZAX-xx-LF

SERIES	LEADFREE
	05~20 WAY
	NON POST
	SINGLE CONTACT
	ZIF
	DIP 90°

煜倫股份有限公司

www.morethanall.com

DESCRIPTION: 2.54mm Pitch FPC Connector