

Material:

1. Insulator: PBT+30% Glass Fiber(Meet UL94V-0).
2. Contact: Copper Alloy.
3. Contact Plated: Gold or Tin over Nickel Plated.
4. Shell: Steel with Nickel or Tin or Zinc Plated.

Specification:

1. Current Rating: 5 Amps.
2. Withstanding Voltage: AC 500V for 1 Minute.
3. Insulation Resistance: 1000MΩ Min. at DC 500V.
4. Contact Resistance: 15mΩ Max..
5. Operating Temperature: -40°C~+105°C.

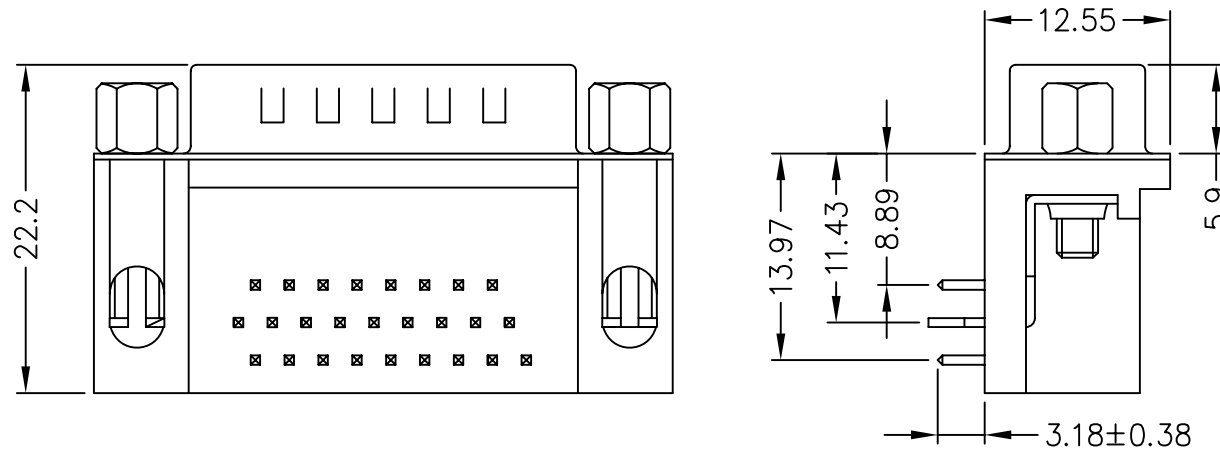

No. of Contacts	Dim. A	Dim. B	Dim. C	Dim. D	Dim. E
15	16.92	24.99	30.81	2.29	0.25
26	25.25	33.32	39.14	2.29	0.51
44	38.96	47.04	53.04	2.29	0.51
62	55.42	63.50	69.32	2.41	0.58

RoHS Compliant

TOLERANCES ARE

MORETHANALL
PCB CONNECTORS
Cable ASSEMBLIES

DRAWING BY CY

CHECKED BY GENIUS

UNIT / mm

SCALE 1 : 1

DATE

SIZE A4

PPOJECTION

X. ±
.X ± 0.30
.XX ± 0.15
.XXX ±
ANG ±

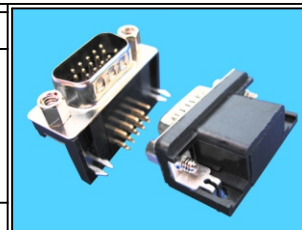

ORDER INFORMATION

HDR-PG-xx-LF
SERIES | LEADFREE
15~62WAY
FULL GOLD
MALE

煜倫股份有限公司

www.morethanall.com

DESCRIPTION: Hi-Density D-Sub Right Angle Male Connector 8.89mm With Locking Screw Type