

### Features:

- 2 ~ 10 circuits available
- Pin Material: Tin-plated phosphor bronze

### Specification:

- Current rating: 13A (2~4P), 11A (6~10P)
- Voltage rating: 600V
- Dielectric withstanding voltage: 5000V AC/minute
- Ambient temperature rise: -55°C ~ 105°C

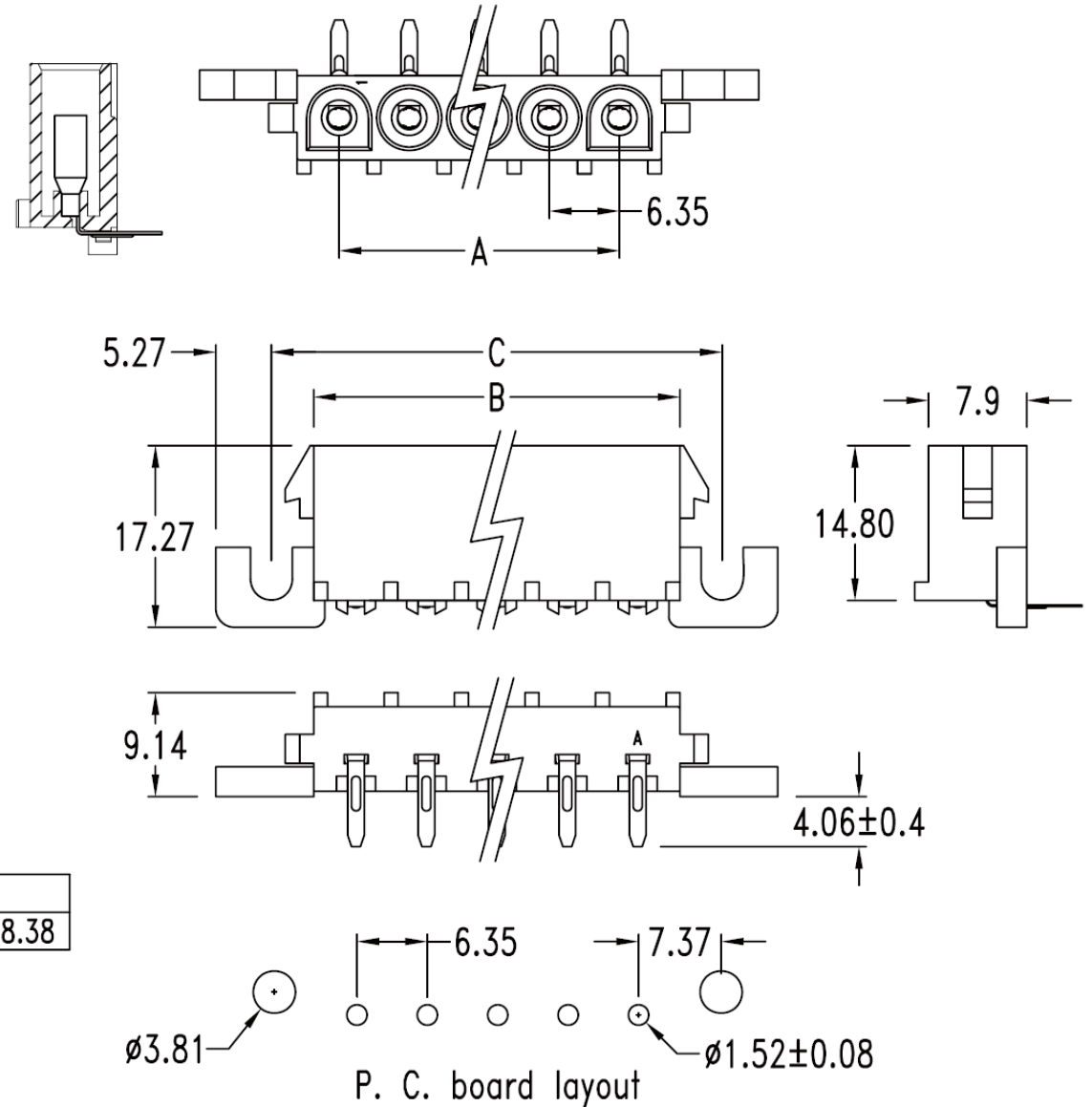

### Dimensional Information ( mm )

Circuits	Dim. A	Dim. B	Dim. C
N	6.35 x ( N - 1 )	6.35 x N + 1.27	6.35 x N + 8.38

&& N = 2 ~ 10

**MORETHANALL**  
PCB CONNECTORS  
Cable ASSEMBLIES

煜倫股份有限公司

www.morethanall.com

**RoHS Compliant**

DRAWING BY CY

CHECKED BY GENIUS

UNIT/ mm SCALE 1:1

DATE

SIZE A4

P PROJECTION

TOLERANCES ARE

X. ±  
.X ±  
.XX ±  
.XXX ±  
ANG ±

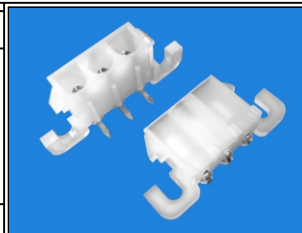

### ORDER INFORMATION

UL-SRE-1Xxx-LF  
SERIES | LEADFREE  
1X02:02WAY  
1X10:10WAY  
EAR  
DIP 90°  
FEMALE

DESCRIPTION: